

# Locality Map

- Legend**
- Mining Area and Surrounds
  - Surrounds
  - Artificial surfaces
  - EXCAVATION
  - Buildings
  - HOUSE
  - Inland water
  - DAM
  - River
  - NON-PERENNIAL CENTER LINE
  - PERENNIAL CENTER LINE
  - Roads
  - MAIN ROAD
  - N1
  - OTHER ACCESS
  - Vegetation
  - CULTIVATED LAND
  - TREE
  - Water source
  - WINDPUMP
  - Property Details
  - Remaining Extent of the farm Bloemhof 14
  - Free State Province
  - Parent farms
  - Magisterial districts: PARYS
  - Farm portions
  - Administrative region: PARYS
  - Ngwathe Local Municipality
  - Fezile Dabi District Municipality
  - 1:50000 scanned sheets

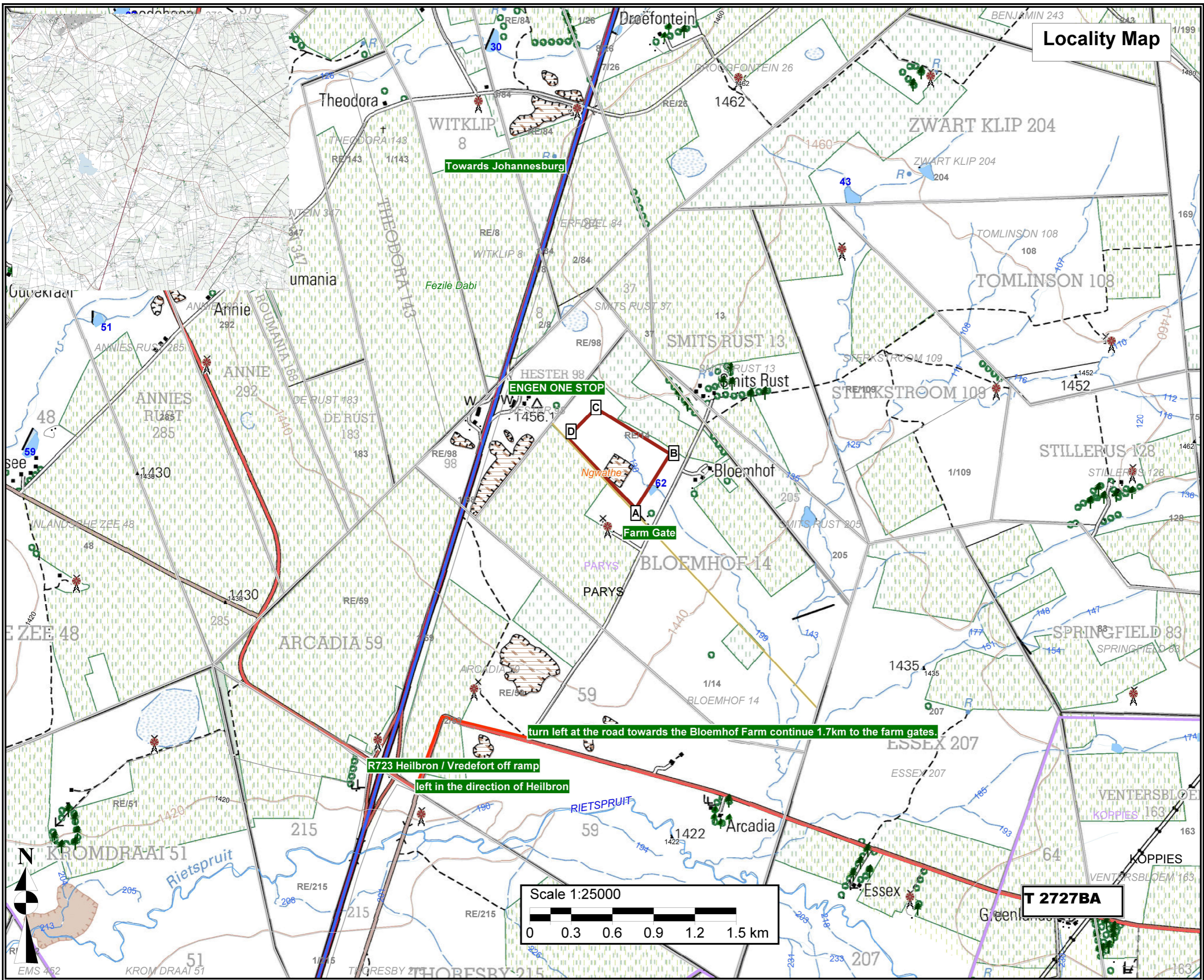

turn left at the road towards the Bloemhof Farm continue 1.7km to the farm gates.

R723 Heilbron / Vredefort off ramp

left in the direction of Heilbron

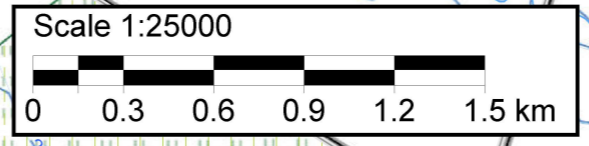

Proposed mining area coordinates:  
 A27.0548894°S; 27.5625444°E  
 B27.0513029°S; 27.5650583°E  
 C27.0483198°S; 27.5596529°E  
 D27.0502365°S; 27.5575594°E  
 A27.0548894°S; 27.5625444°E

A27°3'17.6018"S; 27°33'45.1598"E  
 B27°3'4.6904"S; 27°33'54.2098"E  
 C27°2'53.9513"S; 27°33'34.7504"E  
 D27°3'0.8514"S; 27°33'27.2138"E  
 A27°3'17.6018"S; 27°33'45.1598"E

Mining right application area:  
 25.4 ha

Client:



Consultant:



**T 2727BA**