

Plan showing land uses of the area

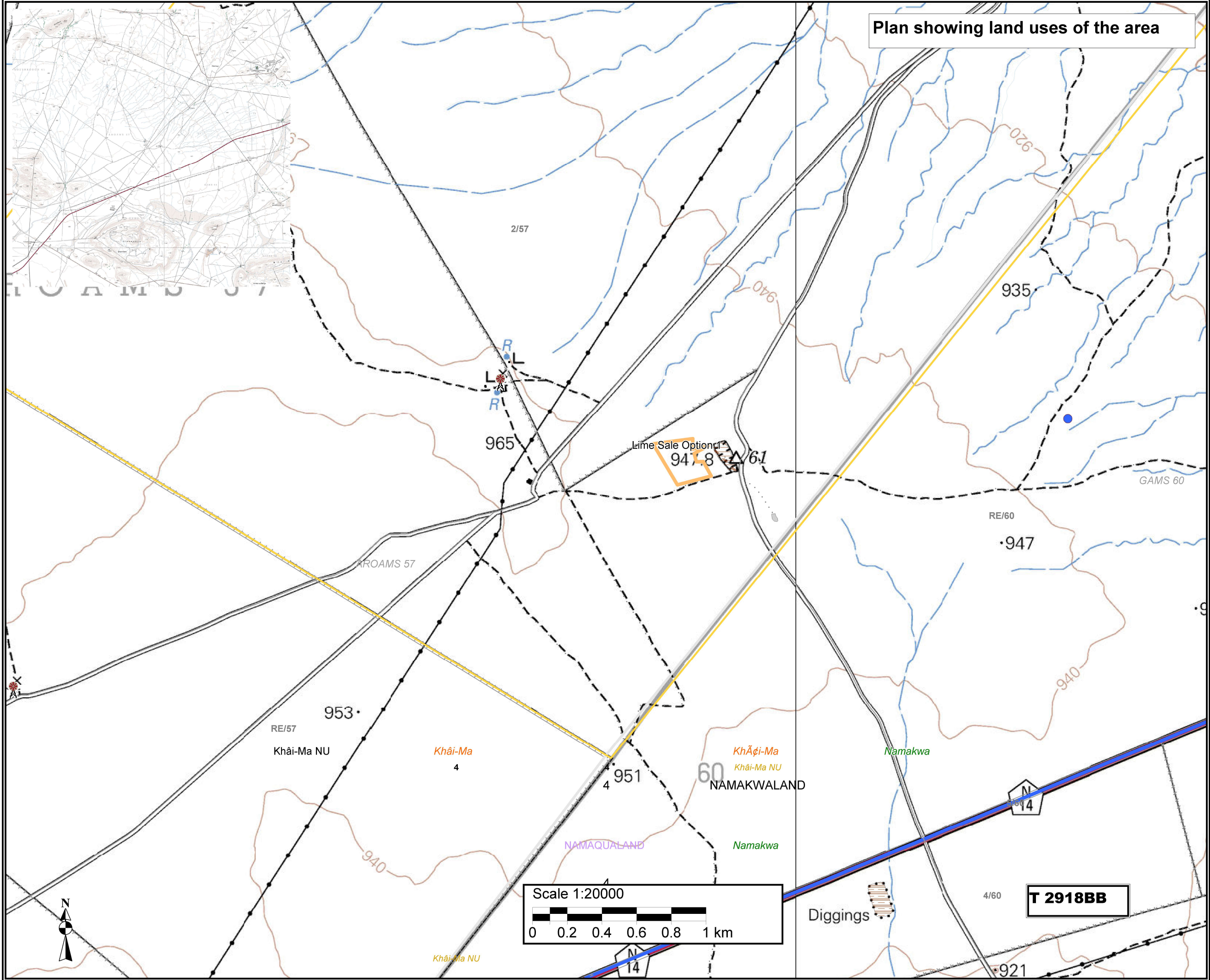

- Legend**
- Artificial surfaces
  - EXCAVATION
  - MINE DUMP
  - Barriers
  - FENCE
  - Buildings
  - HOUSE
  - River
  - NON-PERENNIAL CENTER LINE
  - Roads
  - N14
  - OTHER ACCESS
  - TRACK FOOTPATH
  - Water source
  - RESERVOIR
  - WINDPUMP
  - Mining Permit Area
  - Northern Cape
  - Namakwa District Municipality
  - Khâci-Ma Local Municipality
  - Ward no 4
  - Mining Permit area
  - Mining area
  - Towns
  - NAMAQUALAND - Administrative region
  - Farm portions
  - NAMAKWALAND - Magisterial district
  - Parent farms
  - Property boundary

**Proposed mining area coordinates:**  
 A29.169437°S; 18.993921°E  
 B29.169706°S; 18.991556°E  
 C29.171831°S; 18.993001°E  
 D29.17137°S; 18.995006°E  
 E29.170623°S; 18.994533°E  
 F29.170638°S; 18.994127°E  
 G29.170204°S; 18.994001°E  
 H29.169813°S; 18.994826°E  
 I29.16997°S; 18.993916°E  
 J29.169909°S; 18.993901°E  
 A29.169437°S; 18.993921°E

A29°10'9.973"S; 18°59'38.116"E  
 B29°10'10.942"S; 18°59'29.602"E  
 C29°10'18.592"S; 18°59'34.804"E  
 D29°10'16.932"S; 18°59'42.022"E  
 E29°10'14.243"S; 18°59'40.319"E  
 F29°10'14.297"S; 18°59'38.857"E  
 G29°10'12.734"S; 18°59'38.404"E  
 H29°10'11.327"S; 18°59'41.374"E  
 I29°10'11.892"S; 18°59'38.098"E  
 J29°10'11.672"S; 18°59'38.044"E  
 A29°10'9.973"S; 18°59'38.116"E

Mining permit application area:  
 5.0 ha

**Client:**  
 Limesales (Pty) Ltd

**Consultant:**

